

Magnetic Transducer (External Drive)

Model: SMT4020T-40A3-17



ELECTRICAL SPECIFICATIONS

	Condition	Parameter	Unit
Operating Voltage		2 ~ 4	Vo-p
Rated Voltage		3	Vo-p
Rated Current	at rated voltage, resonant freq., square wave [duty 50%]	Max. 90	mA
DC Resistance		17 ± 3	Ω
Resonant Frequency		4000	Hz
Sound Pressure Level	at 10cm, rated voltage, resonant freq., square wave [duty 50%]	Min. 70	dBa
Terminal		SMT (Copper with tin plating)	
Operating Temperature		-20 ~ +70	°C
Housing Material		LCP	
Weight		0.1	g

Notes: Parameter applying at recommended driving circuit [hFE >200, min. 2.5mA]

MECHANICAL DRAWING

Dimensions in mm

Tolerance ±0.3mm Except Specified

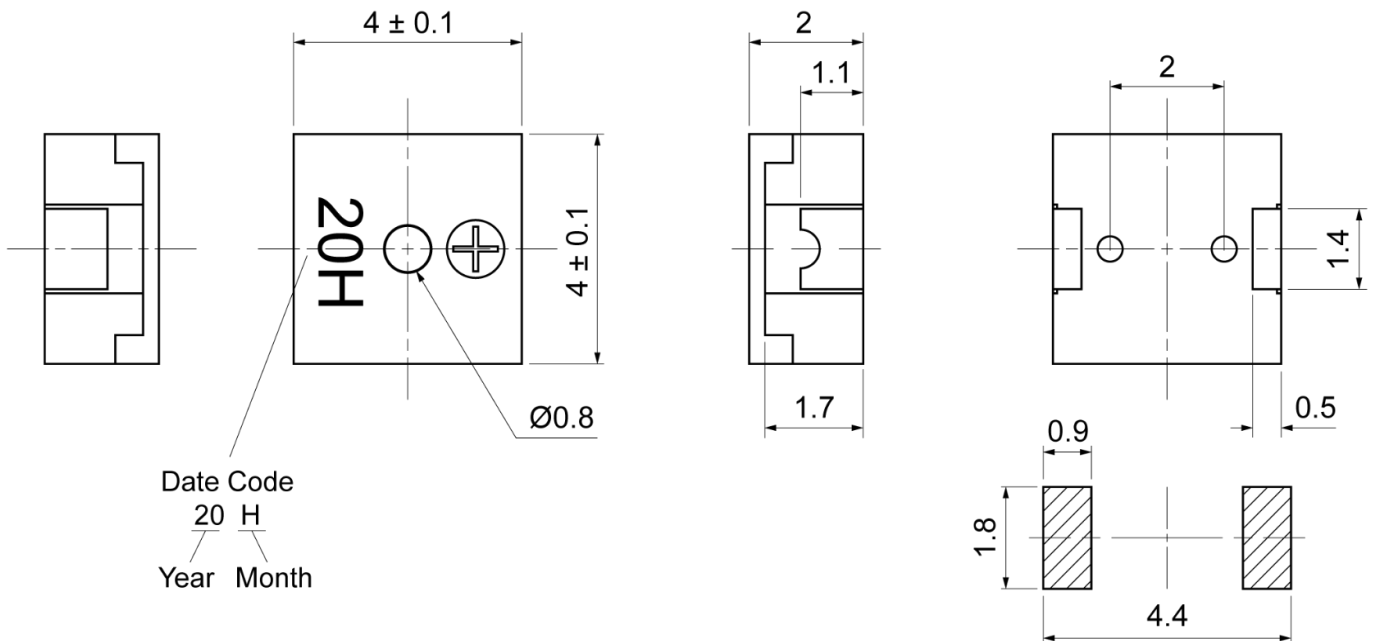

Recommended PCB Layout